

**START** **1** Resistor - Weerstand - Résistance - Widerstand - Resistencia - Motstand - Vastus - Resistenze

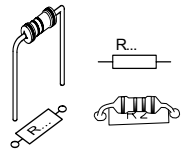

◇ R1 ... R4 : 1K

(Brown, Black, Red) - (Bruin, Zwart, Rood) - (Brun, Noir, Rouge) - (Braun, Schwarz, Rot) - (Brun, Svart, Röd) - (Ruskea, Musta, Punainen) - (Marrón, Negro, Rojo) - (Castanho, Preto, Encarnado) - (Marrone, Nero, Rosso)

◇ R5 ... R11 : 100K

(Brown, Black, Yellow) - (Bruin, zwart, Geel) - (Brun, noir, Jaune) - (Braun, Schwarz, Gelb) - (Brun, Svart, Gul) - (Ruskea, Musta, Keltainen) - (Marrón, Negro, Amarillo) - (Castanho, Preto, Amarelo) - (Marrone, Nero, Giallo)

**2** Diodes

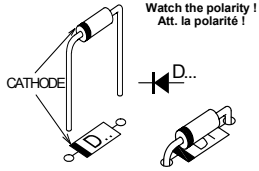

Watch the polarity!  
Att. la polarité!

◇ D1 ... D3 : 1N4148

**3** IC-socket

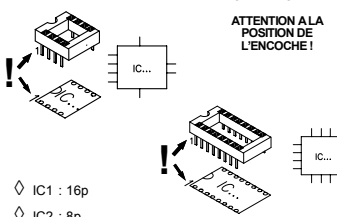

WATCH THE POSITION OF THE NOTCH!

ATTENTION A LA POSITION DE L'ENCOCHE!

◇ IC1 : 16p  
◇ IC2 : 8p

**4** Capacitors



◇ C1 : 100nF (104)  
◇ C2 : 100nF (104)  
◇ C3 : 100nF (104)

**5** Voltage regulator

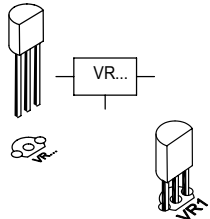

◇ VR1 : UA78L06

**6** PCB pins

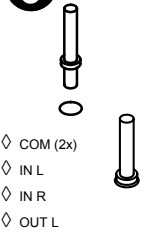

◇ COM (2x)  
◇ IN L  
◇ IN R  
◇ OUT L  
◇ OUT R  
◇ + } 9 / 12V DC  
◇ - }

**7** Electrolytic capacitor

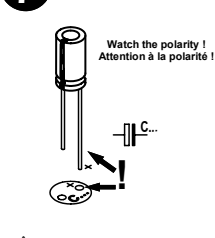

◇ C4 ... C7 : 4,7µF  
◇ C8 ... C10 : 47µF  
◇ C11 : 100µF

**8** IR-receiver

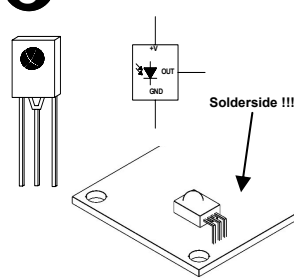

◇ IRx1 : IR38DM

**9** Led's

◇ LD1 : 3mm Red 'Power'  
◇ LD2 : 3mm Red 'Rx'

**Solderside !!!**

**10** Push buttons

◇ SW1 : KRS06149 'UP'  
◇ SW2 : KRS06149 'DOWN'

**11** IC's

◇ IC1 : TC9413AP  
◇ IC2 : VMK163 (programmed Pic12F629)

**Schematic diagram**

**FROM SOURCE**

**TO AMPLIFIER**

**VOLUME**

SW1 :

SW2 :

SW1+SW2 : MUTE